

These valves are compact in size and are the smallest 3-way solenoid valves manufactured by UNIVER. The body is made of a hot-pressed techno-polymer. They are mainly used to send pneumatic commands and directly receive electric impulses from PLCs or other integrated control systems; in general they are used to control higher capacity valves, but can also be used to directly control single-acting 8 ÷ 12 mm-diameter micro-cylinders; in this case, they are installed on sub-bases and mounted in valve blocks. Interchangeable U04 coils are coupled with these valves which fix to the body with a spring clip and can be rotated at 180° intervals. The response times can be considerably reduced with the support of control electronics. Today, these valves are widely used in various industrial sectors like, for instance, textile machines, filling machines in the medical sector, vending machines, etc.

TECHNICAL CHARACTERISTICS

Valves made of a thermoplastic material, with internal parts in stainless steel and brass; seals are in nitrilic rubber. They can be mounted on a single sub-base or a 2-20 position, aluminium multiple sub-base. Assembly is guaranteed by 2 M1,7 self-shaping screws (standard supplied).

Fluid: 10 μ filtered industrial air, lubricated or not lubricated
 Fluid temperature: 0 +55°C
 Ambient temperature: -5 +50°C
 Cycles per minute: 3000 max.
 Input: 1,2 W (1,35 W with led, except for B-022N)
Coil: interchangeable **U04** part number DE-... (section accessories page 10-V).
 Electrical connections:
 MOLEX-type female bipolar connector or with loose wires (Section Accessories page 12-V).

NOTE: an indicative estimate of the factor "CV" can be obtained by dividing the capacity values expressed in NI/min by "962"

昊盛国际发展有限公司
 电话: 0592-6054592
 传真: 0592-6054591
<http://www.housengj.com>

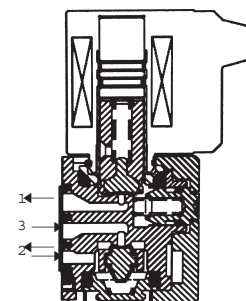
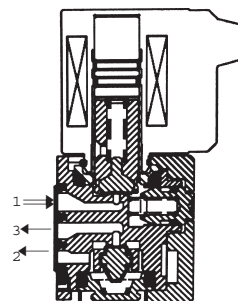
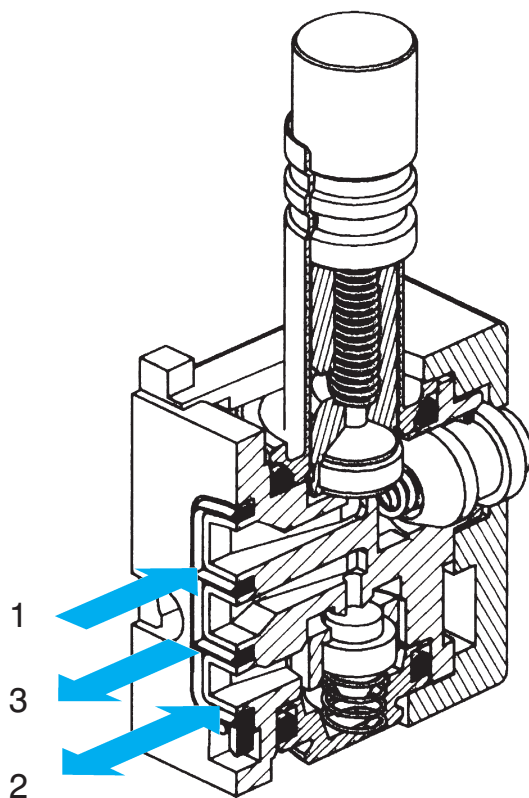





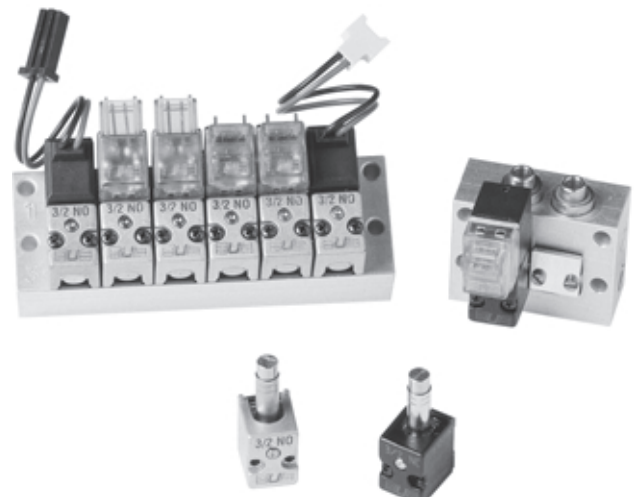

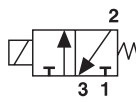

- 1 = Input
- 2 = Application
- 3 = Exhaust

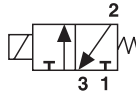
- 1 = Exhaust
- 2 = Application
- 3 = Input

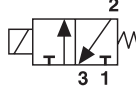

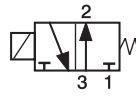

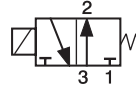
Type	Symbol	Ways	Pressure bar	Nominal diameter	Capacity NI/min.	Power supply	Time ms energ. (14) de-energ. (12)	Mass kg*	Part number
		3/2 NC	1,5 \div 8	0,5	1→2=9 2→3=12	12 V.c.c. 24 V.c.c.	9,5 10	0,007 (0,012)	B-101N
		3/2 NC	1,5 \div 8	0,5	1→2=9 2→3=12	12 V.c.c. 24 V.c.c.	9,5 10	0,007 (0,012)	B-101U
		3/2 NC	1,5 \div 8	0,6	1→2=12 2→3=15	12 V.c.c. 24 V.c.c.	9,5 9	0,007 (0,012)	B-102N
		3/2 NO	0 \div 8	0,5	3→2=9 2→1=10	12 V.c.c. 24 V.c.c.	18 8	0,007 (0,012)	B-121N
		3/2 NO	5 \div 7	0,6	3→2=12 2→1=15	12 V.c.c. 24 V.c.c.	11 9	0,007 (0,012)	B-022N

◇ 0 bar operation upon request.

* The value in brackets indicates the mass with coil (kg 0,015 with loose wires)

**Overall dimensions
B-101N/B-022N/B-121N**

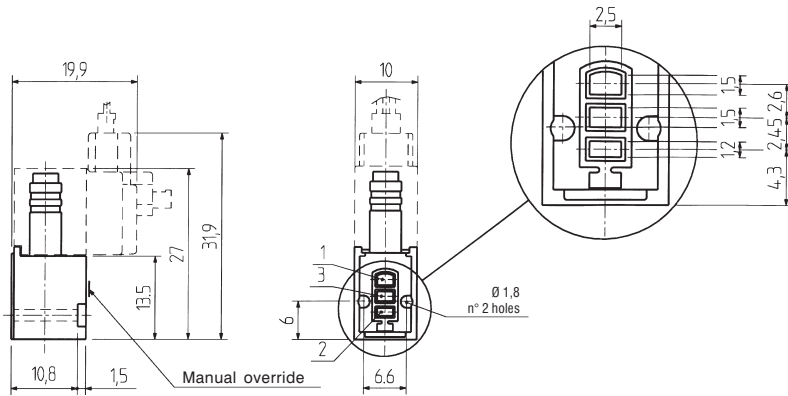

B-101U

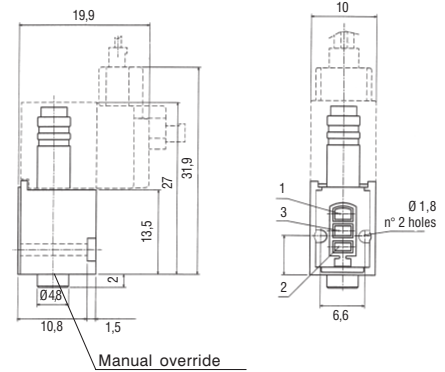

Working dimensions for valve application

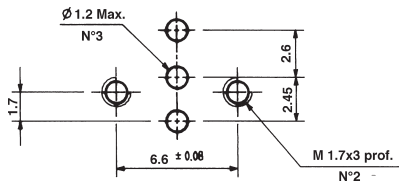

昊盛国际发展有限公司
电话: 0592-6054592
传真: 0592-6054591
<http://www.housengj.com>

Overall dimensions B-102N

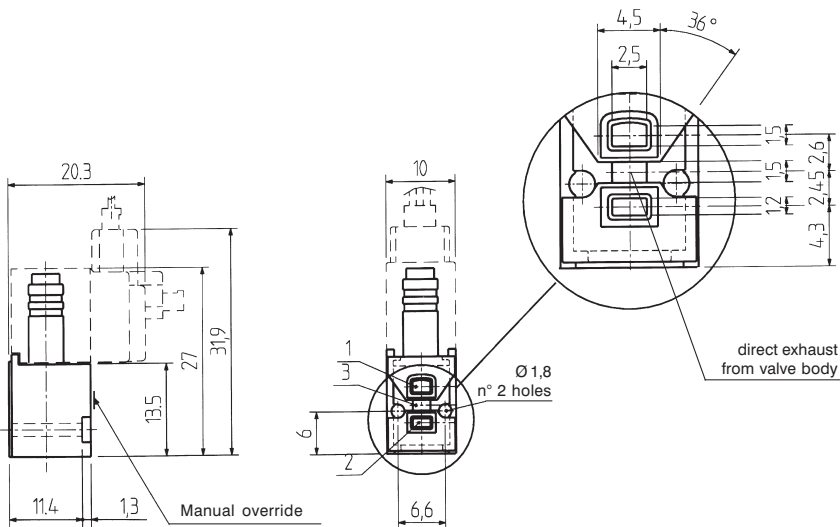

Working dimensions for valve application

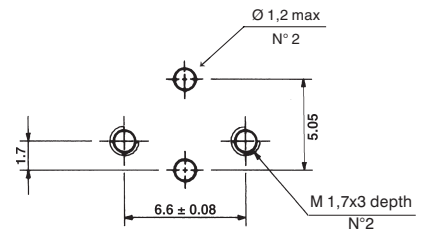

昊盛国际发展有限公司
<http://www.housengj.com>